

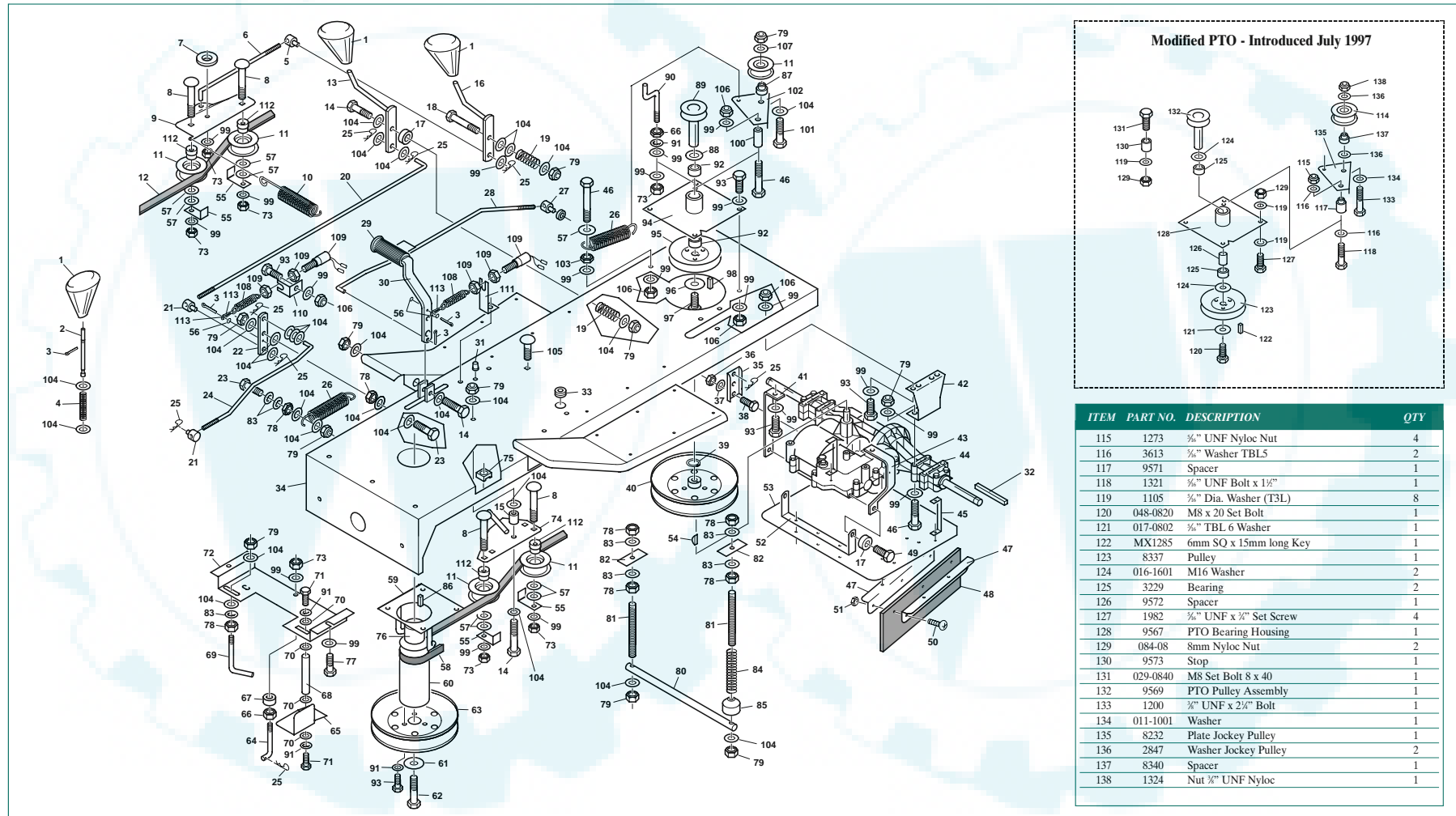

**Westwood**

# Tractor Chassis, PTO, Brake & Cutter Controls



| ITEM | PART NO. | DESCRIPTION               | QTY |
|------|----------|---------------------------|-----|
| 115  | 1273     | 3/8" UNF Nyloc Nut        | 4   |
| 116  | 3613     | 3/8" Washer TBL5          | 2   |
| 117  | 9571     | Spacer                    | 1   |
| 118  | 1321     | 3/8" UNF Bolt x 1 1/2"    | 1   |
| 119  | 1105     | 3/8" Dia. Washer (T3L)    | 8   |
| 120  | 048-0820 | M8 x 20 Set Bolt          | 1   |
| 121  | 017-0802 | 3/8" TBL 6 Washer         | 1   |
| 122  | MX1285   | 6mm SQ x 15mm long Key    | 1   |
| 123  | 8337     | Pulley                    | 1   |
| 124  | 016-1601 | M16 Washer                | 2   |
| 125  | 3229     | Bearing                   | 2   |
| 126  | 9572     | Spacer                    | 1   |
| 127  | 1982     | 3/8" UNF x 3/4" Set Screw | 4   |
| 128  | 9567     | PTO Bearing Housing       | 1   |
| 129  | 084-08   | 8mm Nyloc Nut             | 2   |
| 130  | 9573     | Stop                      | 1   |
| 131  | 029-0840 | M8 Set Bolt 8 x 40        | 1   |
| 132  | 9569     | PTO Pulley Assembly       | 1   |
| 133  | 1200     | 3/8" UNF x 2 1/4" Bolt    | 1   |
| 134  | 011-1001 | Washer                    | 1   |
| 135  | 8232     | Plate Jockey Pulley       | 1   |
| 136  | 2847     | Washer Jockey Pulley      | 2   |
| 137  | 8340     | Spacer                    | 1   |
| 138  | 1324     | Nut 3/8" UNF Nyloc        | 1   |

THE BEST OF BRITISH ENGINEERING